



**GENERAL NOTES:**

1. ALL DIMENSIONS AND LEVELS TO BE VERIFIED ON SITE PRIOR TO COMMENCEMENT OF THE WORKS. ANY DISCREPANCIES TO BE REPORTED TO THE ENGINEER.
2. THIS DRAWING IS TO BE READ IN CONJUNCTION WITH THE RELEVANT ARCHITECT'S AND OTHER ENGINEERING DRAWINGS.

**SITE LEVELS LEGEND**

- ◆ +10.00 EXISTING LEVEL
- ◆ +10.00 PROPOSED FOOTPATH/GARDEN LEVEL
- ◆ +10.00 PROPOSED ROAD LEVEL
- PROPOSED SURFACE GRADIENT
- RETAINING WALL <1.5m HIGH
- RETAINING WALL >1.5m HIGH
- 450mm RETAINING WALL TO ARCHITECTS SPECIFICATION
- 300mm MAX RETAINING WALL TO ARCHITECTS SPECIFICATION
- BOUNDARY WALL TO ARCHITECTS SPECIFICATION
- UNIT 1 FFL 100.450 PROPOSED FINISHED FLOOR LEVEL
- 20.765 — CH10 CHAINAGE AND LEVEL

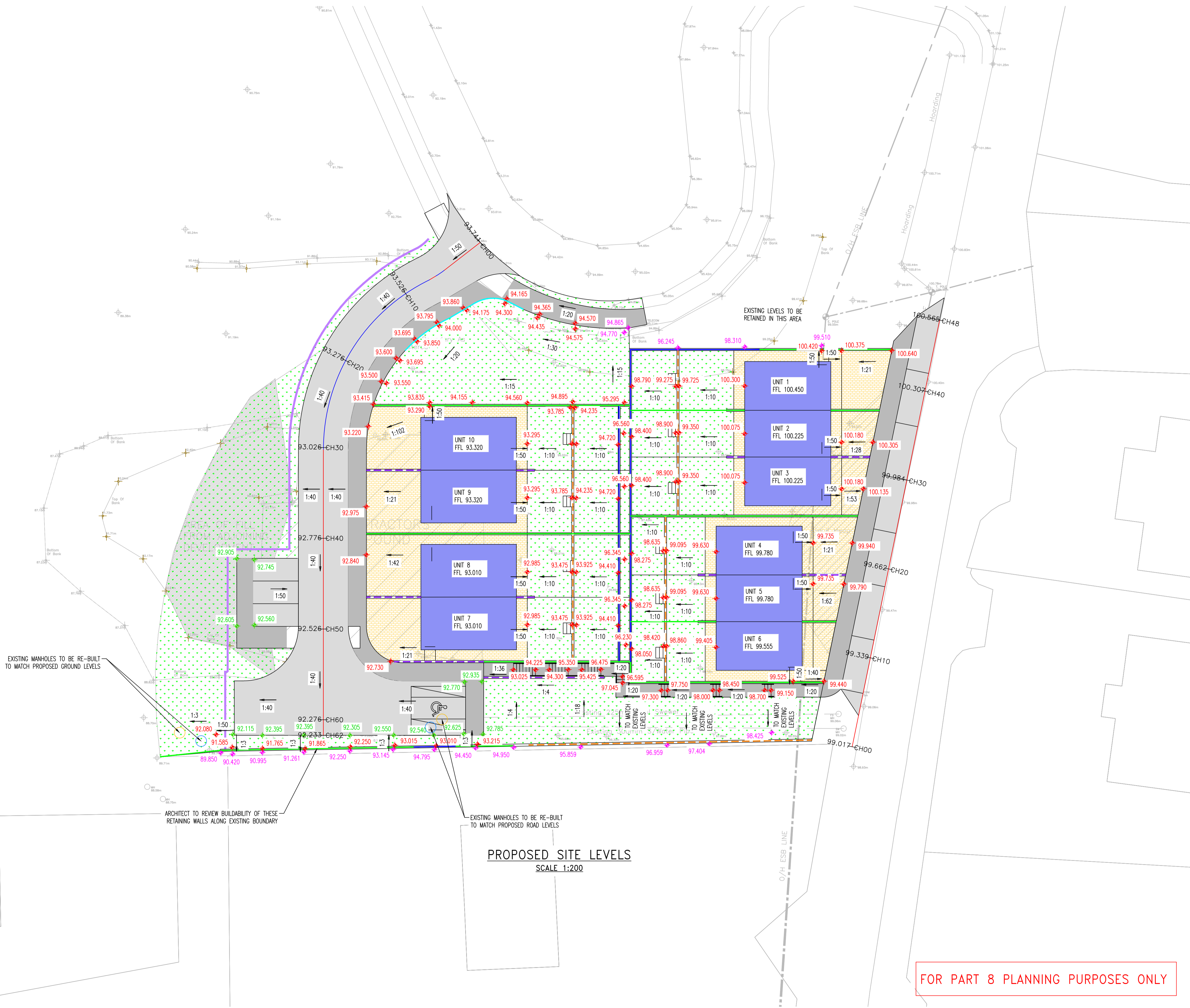

EXISTING MANHOLES TO BE RE-BUILT TO MATCH PROPOSED GROUND LEVELS

ARCHITECT TO REVIEW BUILDABILITY OF THESE RETAINING WALLS ALONG EXISTING BOUNDARY

EXISTING MANHOLES TO BE RE-BUILT TO MATCH PROPOSED ROAD LEVELS

**PROPOSED SITE LEVELS**  
SCALE 1:200

FOR PART 8 PLANNING PURPOSES ONLY

|     |          |  |    |      |
|-----|----------|--|----|------|
| REV | DATE     | DESCRIPTION                                    | BY | APPR |
| B   | 03.11.21 | MINOR REVISIONS                                | SM | MK   |
| A   | 18.10.21 | SITE LEVELS UPDATED TO REFLECT NEW SITE LAYOUT | SM | MK   |

DRAWING STATUS:  
**PART\_8\_PLANNING**

CLIENT:  
**WICKLOW COUNTY COUNCIL**

JOB DESCRIPTION:  
10No. UNIT HOUSING DEVELOPMENT, BALLYNERRIN, WICKLOW TOWN, CO. WICKLOW

DRAWING TITLE:  
**PROPOSED SITE LEVELS**

PROJECT No.: **P-3537** DRAWING No.: **C-04**

REV. No.: **B**

SCALE: 1:200 SHEET: A1 DATE: 30.04.21  
DRAWN BY: SM CHECKED BY: MK APPROVED BY: PMCM

**McMahon Associates**  
Consulting Civil & Structural Engineers, Project Managers  
Environmental Engineers, PSP & Traffic Engineers  
The Mill Building, Newtown Link Road, Greenhills, Drogheda, Co. Louth  
t: 041 2137 050 e: info@mcMahonengineers.com